

FIREYE® Series SS20120 CONSTANT DUTY ELECTRONIC IGNITOR INSTRUCTION SHEET

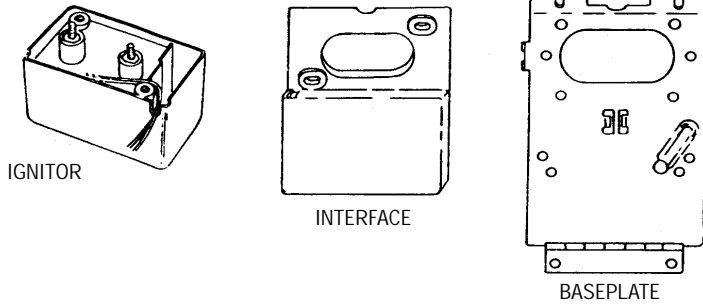

1. Locate blue and white wires on the ignitor (Fig. 1).
2. Tuck wires into slot A on ignitor, then thread blue and white wires thru slot B on the interface (Fig. 2).
3. Slide the interface panel onto the ignitor so the two surfaces are flush (Fig. 3).
4. Locate slot C on baseplate. Thread blue and white wires thru slot B. Slide baseplate onto interface panel until all surfaces are flush together.
5. Secure the ignitor unit with the two #10 x 3/4" sheet metal screws (provided) as shown in Fig. 4.

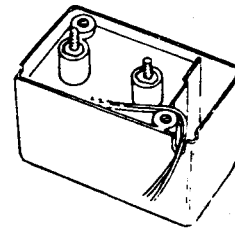

Fig. 1

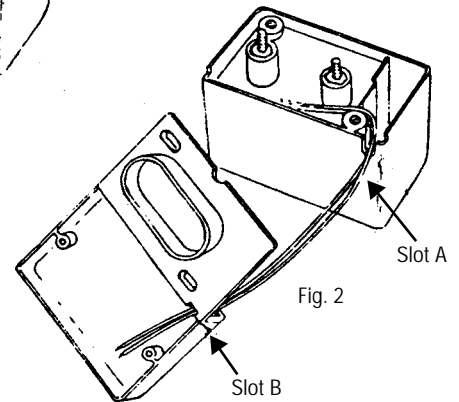

Fig. 2

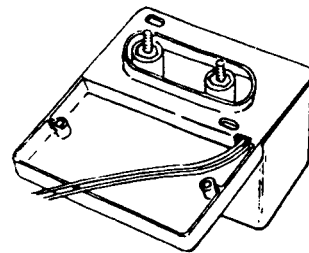

Fig. 3

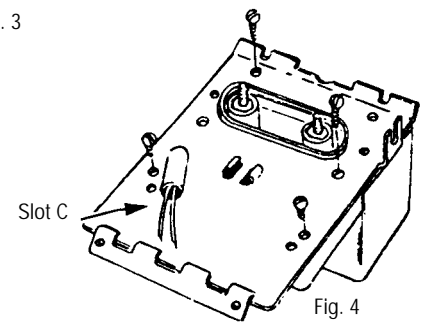
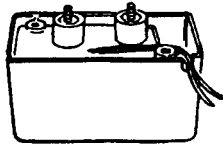

Fig. 4

NOTE: Baseplates may vary according to your specific needs.

BASEPLATE KITS (Ordered Separately)

PART NUMBER	BASE PLATE KITS
SSP-10	CARLIN Residential Base Plate and Interface Kit
SSP-11	CARLIN Small Commercial Base Plate and Interface Kit (201-301)
SSP-12	CARLIN Large Commercial Base Plate and Interface Kit (601-801)
SSP-13	AERO Base Plate and Interface Kit
SSP-14	BECKETT Base Plate and Interface Kit
SSP-15	BECKETT S, SR Base Plate and Interface Kit
SSP-16	ABC BANTOM T-29-15 Base Plate and Interface Kit
SSP-17	SUNRAY D&LC T-34-B Base Plate and Interface Kit
SSP-18	WAYNE HS Base Plate and Interface Kit
SSP-19	WAYNE E Base Plate and Interface Kit
SSP-20	WAYNE M Base Plate and Interface Kit



IGNITOR



INTERFACE

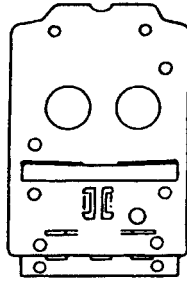

BASEPLATE

FIREYE® Series SS20120 CONSTANT DUTY ELECTRONIC IGNITOR INSTRUCTION SHEET

1. Locate the two wires on the ignitor.
2. Fit wires thru slot A on ignitor and thread through opening on baseplate (Fig.1).
3. Position ignitor onto baseplate and secure loosely with two #10 x 3/4" sheet metal screws (provided).
4. Locate slot B on interface.
5. Fit interface over tabs and onto baseplate, making sure that the wires from slot A continue through slot B (Fig. 2).
6. Ignitor and interface should be flush.
7. Secure interface with remaining two screws (Fig. 3).
8. Tighten the two ignitor screws.

